

**ADAPTABLE**

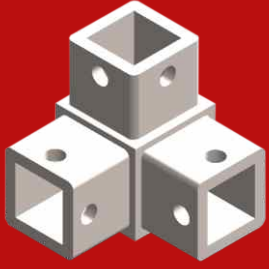

**FLEXIBLE**

**VERSATILE**

**MODUTEC**  
*Simplifying Panel Building*

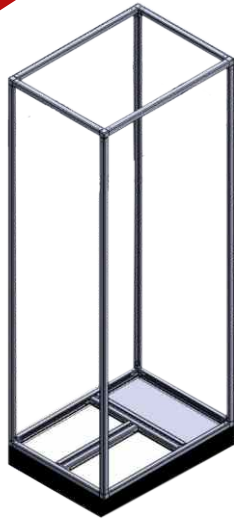

## MODBAY

- Modular
- Bayable
- Form 1 Enclosure
- Mounting Plate
- Accessories
- Single & Double Door.
- Medium & Large Size
- Single & Double Front

STANDARDIZED

SYSTEMATIZED

HELPS YOU SCALE

Today, all major industries have started practicing energy conservation & energy efficiency for the betterment of our world. This has created an increasing opportunity for VFD panels, soft starters panels, PLC, scada & HMI, Control & Relay panels.

On time delivery, world class quality panels to accommodate last minute changes and manage with unskilled manpower are the key needs of system integrators & panel builders to execute such jobs.

To cater to these segments MODUTEC has developed world class quality, modular, form 1 enclosures MODBAY with useful internal spaces, utilitarian designs and time saving methods in execution.

### The design incorporates user friendly features and accessories

- Adjustable punched & pierced profile structure for rigidity & versatility.
- Removable side doors and top covers that are double bent in edges for additional strength.
- Lifting eye bolts with load sharing in XYZ axis with special bracket.
- Baying kit for (attaching adjacent enclosure).
- Plinth with provision for fork lift.
- Robust 3 point locking for doors with good aesthetics & convenience.
- Possibility of offering louvers with filters, fans, limit switch & multiple accessories for mounting.
- Anti vibration pads are available as needed.
- Hinge design allows 120 degree door opening for better internal access & use.
- Door stiffener with punched holes for mounting door components is user friendly.
- Side covers pair consists of 1 LHS & 1 RHS cover. These are interchangeable.

### Supply Includes:

- Frame work is made of 3 Bend Frame bar 2mm thick and punched & Pierced throughout the length of the profile at alternating intervals of 30mm. The pierced holes are tapped to M6.
- 4 Bend cross bars of 2mm thick then go to add further flexibility to the skeleton structures as a required. Here to the profile is punched & pierced through out the length at alternating intervals of 30mm.
- Enclosure with 120 degree aluminum hinged door(s), with door reversible feature of LHS to RHS & versatile stiffener.
- Gland plate at bottom and bolted cover on top.
- Mounting plate - full or partial.
- Accessories for inner door if required.
- Customization if and as required.
- 4 nos eye bolt for lifting.

**MODBAY** **X** **X** **048** **180** **42**

Type	Rear	Width	Height	Depth
1- with mounting plate and rear cover	<b>B</b> Bolted Door	480	180	42
2- with mounting plate and rear door	<b>F</b> Flush Cover	600	198	48
3- without mounting plate and with rear cover	<b>H</b> Hinge Door	780	222	60
4- without mounting plate and with rear door		102		84
		120		

- Type 1 - Enclosure frame (Frame Bar + Cross Bar + Tripod + Top Cover+ Bottom Gland With all fixing accessories + Front Door ) + with mounting plate and rear cover (select B/F).
- Type 2 - Enclosure frame (Frame Bar + Cross Bar + Tripod + Top Cover+ Bottom Gland With all fixing accessories + Front Door ) + with 2 mounting plate and rear door.
- Type 3 - Enclosure frame (Frame Bar + Cross Bar + Tripod + Top Cover+ Bottom Gland With all fixing accessories + Front Door ) + without mounting plate and rear cover (select B/F).
- Type 4 - Enclosure frame (Frame Bar + Cross Bar + Tripod + Top Cover+ Bottom Gland With all fixing accessories + Front Door ) + without mounting plate and rear door.

Accessories:

- Door stay
- Inner Door
- Toughened Glass Door of required size
- Base Plinth in 100 mm version
- Slotted Din Rails on Door stiffener
- Drawing Pocket (Sheet steel or Plastic)
- Cam Lock with external Lock
- Limit switch for door
- LED light fitting ( 100 - 240 V AC )

Material Specification:

Item	Material	Thickness(mm)	Surface finish
Profiles	Galvanised sheet steel	2	Powder coated RAL7032 Texture
Hinged door	CRCA sheet steel	2	Powder coated RAL7032 Texture
Bolted door	CRCA sheet steel	1.6	Powder coated RAL7032 Texture
Front cover	CRCA sheet steel	1.6	Powder coated RAL7032 Texture
Gland plate	CRCA sheet steel	2	Powder coated RAL7032 Texture
Mounting plate	Galvanised sheet steel	3	Galvanised sheet steel

# MODBAY

With Single Door & IP 54 to EN 60529

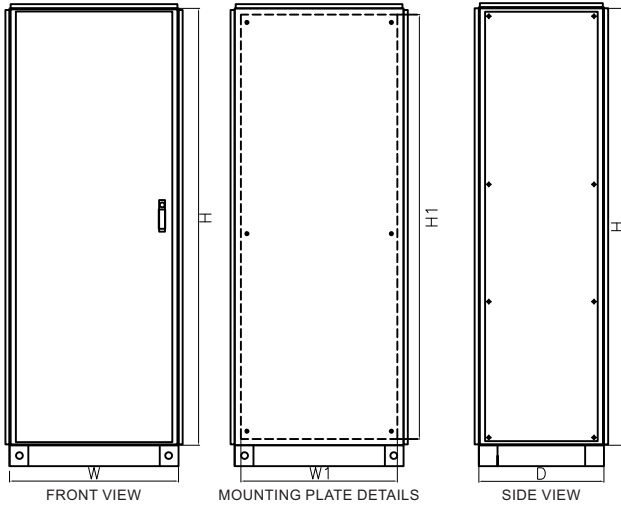

S	CATALOG NUMBER	TİGİĞİEİİİİÖÖÄ			MOUNTING PLATE(mm)	
		WIDTH	HEIGHT	DEPTH	W1	H1
1	MODBAYXX04818042	480	1800	420	420	1740
2	MODBAYXX06018042	600	1800	420	540	1740
3	MODBAYXX07818042	780	1800	420	720	1740
4	MODBAYXX04818048	480	1800	480	420	1740
5	MODBAYXX06018048	600	1800	480	540	1740
6	MODBAYXX07818048	780	1800	480	720	1740
7	MODBAYXX06019842	600	1980	420	540	1920
8	MODBAYXX07819842	780	1980	420	720	1920
9	MODBAYXX07819848	780	1980	480	720	1920
10	MODBAYXX06019860	600	1980	600	540	1920
11	MODBAYXX07819860	780	1980	600	720	1920
12	MODBAYXX06019884	600	1980	840	540	1920
13	MODBAYXX07819884	780	1980	840	720	1920
14	MODBAYXX06022260	600	2220	600	540	2160
15	MODBAYXX07822260	780	2220	600	720	2160
16	MODBAYXX06022284	600	2220	840	540	2160

# MODBAY With Double Door

( Lockable Door on Right ) & IP 54 to EN 60529

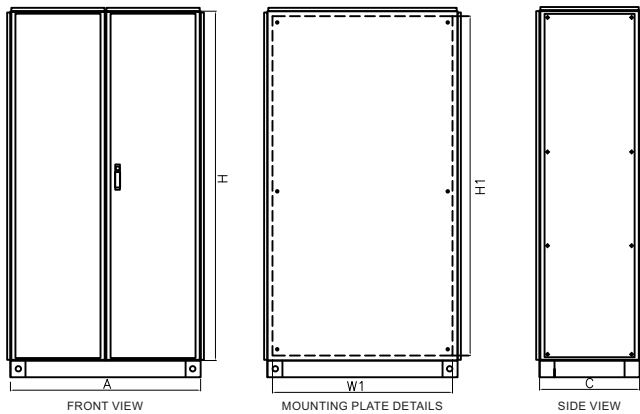

S	CATALOG NUMBER	TİGİĞİEİİİİÖÖÄ			MOUNTING PLATE(mm)	
		WIDTH	HEIGHT	DEPTH	W1	H1
1	MODBAYXX10218042	1020	1800	420	960	1740
2	MODBAYXX12018042	1200	1800	420	1140	1740
3	MODBAYXX10218048	1020	1800	480	960	1740
4	MODBAYXX12018048	1200	1800	480	1140	1740
5	MODBAYXX10219842	1020	1980	420	960	1920
6	MODBAYXX12019842	1200	1980	420	1140	1920
7	MODBAYXX10219848	1020	1980	480	960	1920
8	MODBAYXX12019848	1200	1980	480	1140	1920
9	MODBAYXX10219860	1020	1980	600	960	1920
10	MODBAYXX12019860	1200	1980	600	1140	1920
11	MODBAYXX10219884	1020	1980	840	960	1920
12	MODBAYXX12019884	1200	1980	840	1140	1920
13	MODBAYXX10222260	1020	2220	600	960	2160
14	MODBAYXX12022260	1200	2220	600	1140	2160
15	MODBAYXX10222284	1020	2220	840	960	2160
16	MODBAYXX12022284	1200	2220	840	1140	2160

For increased floor clearance or cable entry convenience, MODBAY is available with a height of 100mm Plinth of sheet steel with 4 corner pieces, 4 cover cap & removable width & depth cover plates.

Surface Finish is to Black color & powder coated.

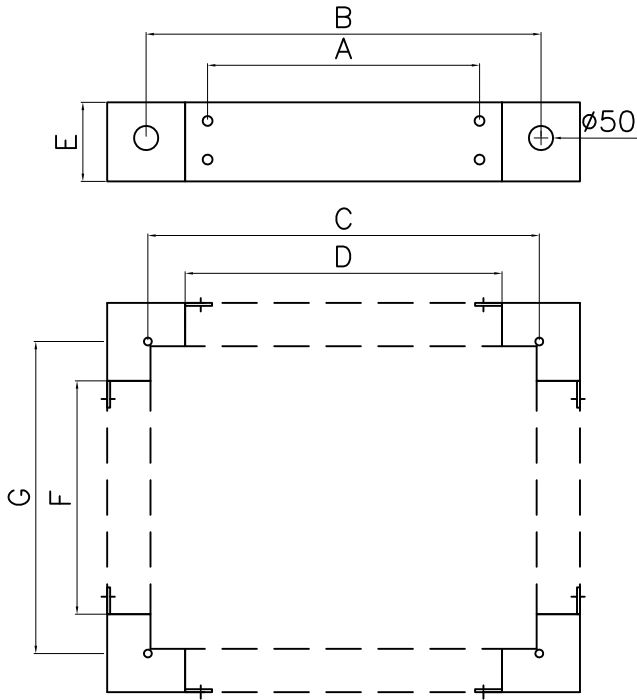

SI No.	ENCLOSURES		CATALOG NUMBER FOR 100mm HEIGHT
	J İĞİÇ	DEPTH	
1	480	420	MODUPLX04804210G
2	600	420	MODUPLX06004210G
3	780	420	MODUPLX07804210G
4	1020	420	MODUPLX10204210G
5	1200	420	MODUPLX12004210G
6	480	480	MODUPLX04804810G
7	600	480	MODUPLX06004810G
8	780	480	MODUPLX07804810G
9	1020	480	MODUPLX10204810G
10	1200	480	MODUPLX12004810G
11	480	600	MODUPLX04806010G
12	600	600	MODUPLX06006010G
13	780	600	MODUPLX07806010G
14	1020	600	MODUPLX10206010G
15	1200	600	MODUPLX12006010G
16	480	840	MODUPLX04808410G
17	600	840	MODUPLX06008410G
18	780	840	MODUPLX07808410G
19	1020	840	MODUPLX10208410G
20	1200	840	MODUPLX12008410G

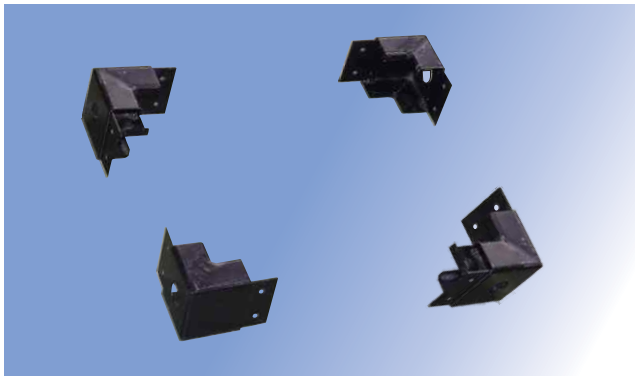

SI No.	PLINTH		A	B	C	D	E	F	G
	J İĞİÇ	DEPTH							
1	480	420	260	380	390	300	100	240	330
2	600	420	380	500	510	420	100	240	330
3	780	420	560	680	690	600	100	240	330
4	1020	420	800	920	930	840	100	240	330
5	1200	420	980	1100	1110	1020	100	240	330
6	480	480	260	380	390	300	100	300	390
7	600	480	380	500	510	420	100	300	390
8	780	480	560	680	690	600	100	300	390
9	1020	480	800	920	930	840	100	300	390
10	1200	480	980	1100	1110	1020	100	300	390
11	480	600	260	380	390	300	100	420	510
12	600	600	380	500	510	420	100	420	510
13	780	600	560	680	690	600	100	420	510
14	1020	600	800	920	930	840	100	420	510
15	1200	600	980	1100	1110	1020	100	420	510
16	480	840	260	380	390	300	100	660	750
17	600	840	380	500	510	420	100	660	750
18	780	840	560	680	690	600	100	660	750
19	1020	840	800	920	930	840	100	660	750
20	1200	840	980	1100	1110	1020	100	660	750

\* All dimensions are in mm

# BAYING KIT FOR MODBAY

Consists of joiner members & hardware as per picture below in L type & straight type to Cat No MODBAYKLT XXXXXXXX or MODBAYKST XXXXXXXX

There are 02 mm sheet steel, zinc plated, passivated...



## L TYPE

Sl.No	ENCLOSURE		CATALOG NUMBER FOR L TYPE BAYING KIT
	HEIGHT	DEPTH	
1	1800	420	MODBAYKLT180042X
2	1980	420	MODBAYKLT198042X
3	2220	420	MODBAYKLT222042X
4	1800	480	MODBAYKLT180048X
5	1980	480	MODBAYKLT198048X
6	2220	480	MODBAYKLT222048X
7	1800	600	MODBAYKLT180060X
8	1980	600	MODBAYKLT198060X
9	2220	600	MODBAYKLT222060X
10	1800	840	MODBAYKLT180084X
11	1980	840	MODBAYKLT198084X
12	2220	840	MODBAYKLT222084X

## Straight TYPE

Sl.No	ENCLOSURE		CATALOG NUMBER FOR STRAIGHT TYPE
	HEIGHT	DEPTH	
1	1800	420	MODBAYKST180042X
2	1980	420	MODBAYKST198042X
3	2220	420	MODBAYKST222042X
4	1800	480	MODBAYKST180048X
5	1980	480	MODBAYKST198048X
6	2220	480	MODBAYKST222048X
7	1800	600	MODBAYKST180060X
8	1980	600	MODBAYKST198060X
9	2220	600	MODBAYKST222060X
10	1800	840	MODBAYKST180084X
11	1980	840	MODBAYKST198084X
12	2220	840	MODBAYKST222084X

## MOUNTING PLATE INFILL

For a continuous mounting surface in MODBAY when bayed, this closes the gap. These are of 02mm galvanized sheet steel.

Sl.No	HEIGHT	CATALOG NUMBER
	1	
2	1980	MODUMPF198XXX10G
3	2220	MODUMPF222XXX10G

